

PART NUMBER

JBS-101-01



JOURNEY BETTER
LEVELING KITS

SCAN HERE: To watch a video of this installation



BEFORE YOU BEGIN

PRIMARY APPLICATIONS

- > Ford F-150 4 X 4
(2015 - present)
- *Will NOT fit Raptor Models

PARTS LIST

Item	Part #	Description	QTY
A	411001	JBS Shock	2
B	412001	2" Lift Spacer	2
C	412002	JBS Spring Seat	2
D	412003	JBS Shock Cap	2
E	412201	M12-1.75 x 90mm Hex Bolt	4
F	412202	M12 Lock Nut	6
G	412203	M12 Flat Washer	8

TOOLS REQUIRED

- > Floor Jack
- > Jack Stands
- > Wheel Chocks
- > Heavy Duty Spring Compressor
- > Torque Wrench
- > Metric Sockets/Wrenches
- > Metric Allen Keys
- > Paint Pen (or similar)

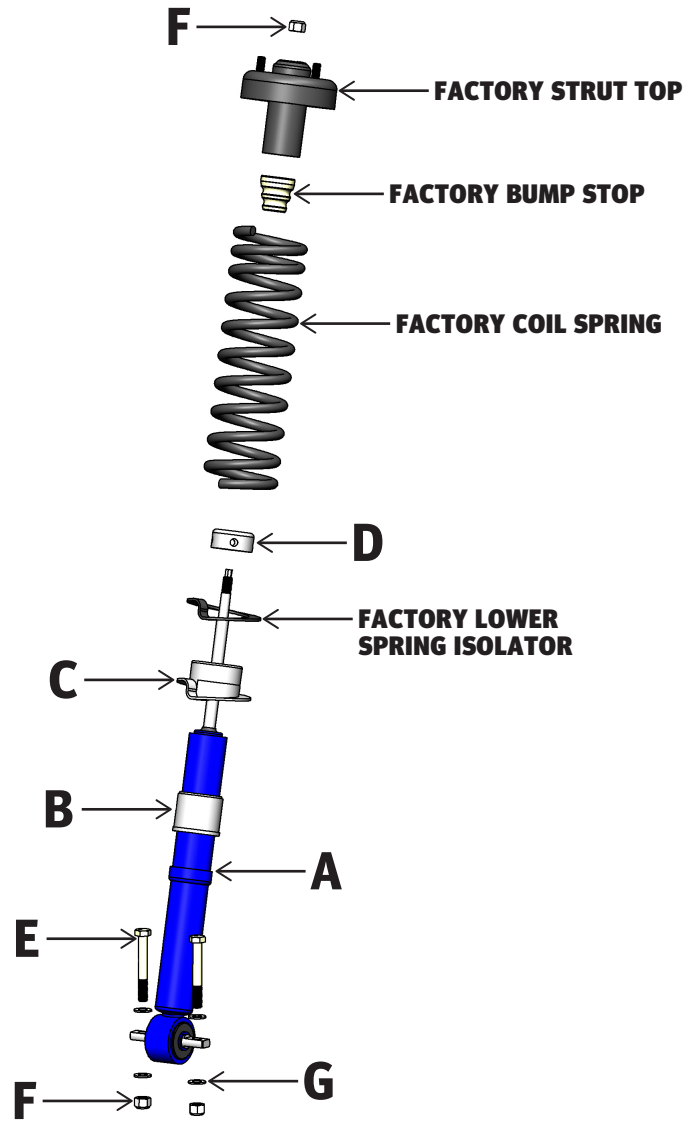

DRIVER SIDE (PASSENGER SIDE SIMILAR)

Part Number: JBS-101-01

Product Line: JOURNEY BETTER LEVELING KITS

Page 1

Questions or Concerns?

Scan here:



or visit:
superspringsinternational.com

SAFETY NOTICE: We recommend installation be done by a professional or persons with sound mechanical knowledge.

WARNING: These instructions are a general guide for installation. SuperSprings International (SSI) assumes no liability for the actual installation process. Consumers and installers should apply common automotive safety practices when raising and working on any vehicle. **Do not put yourself in a position where, if the vehicle were to move unexpectedly, you may be injured.** SSI's products are designed to improve vehicle ride quality. Do not load any vehicle beyond the manufacturer's specifications.

Never exceed the manufacturer's Gross Vehicle Rating (GVWR) located on your vehicles identification tag.

BEFORE INSTALLATION: Ensure the vehicle is on a hard level surface, the parking brake is ON, with the ignition OFF, and place chocks in front of and behind the tires to prevent the vehicle from moving.

DURING AND/OR AFTER INSTALLATION: Ensure emergency brake cables are not touching the SSI products. Secure any cables out of the way with zip ties or by re-routing. Ensure all A/C lines, brake cables, and frame are clear of contact or interference.

PART NUMBER

JBS-101-01



JOURNEY BETTER
LEVELING KITS

INSTALLATION

BEFORE YOU BEGIN:

It is important to read all instructions carefully and familiarize yourself with all components, tools, and procedures needed to complete the installation. SuperSprings International (SSI) recommends that this installation be done by a qualified mechanic at a properly equipped facility. A factory repair manual should be referenced for detailed information about this vehicle. These instructions are to serve as a supplemental guide for SSI specific parts.

1. Park the vehicle on a hard, level surface and engage the emergency brake. Place chocks in front and behind the rear wheels to prevent rolling.
2. Break loose but do not remove the front lug nuts to ease removal when the wheels are in the air.
3. Raise the front of the vehicle and allow the axle to hang so the wheels are 6-8 inches off the ground.
4. Support chassis with jack stands. Observe all safety precautions and wear safety glasses.
5. Remove the front wheels.
6. Starting on the driver side, loosen but do not remove the three nuts that secure the top of the strut to the frame. **Caution: DO NOT loosen or remove the center nut from the shock shaft.**
7. Disconnect the sway bar from the sway bar end link.
8. Locate the bolts that connect the lower control arm to the frame. Before removing any components, use a paint pen (or similar) to mark the location of the adjustment cams (or bolts) for reference later.
9. Remove the two bolts and nuts that attach the lower control arm to the frame.
10. Remove the two nuts that connect the lower shock mount to the lower control arm.
11. Push the lower control arm and spindle downward and outboard until clear of the lower shock studs.
12. Moving to the top of the strut, remove the three previously loosened nuts that secure the top of the strut to the frame. **Caution: DO NOT loosen or remove the center nut from the shock shaft.**
13. Lower the strut assembly downward and then up and out to remove from the vehicle.
14. To ensure proper alignment, use a paint pen to mark the relationship of the lower spring seat to the coil spring, upper and lower spring isolators, strut body, and strut top mount.
CAUTION: SuperSprings Int. recommends using a heavy duty spring compressor for disassembly of the strut. If you do not have the proper tools, it is recommended to take the struts to a professional.
15. Compress the coil spring to remove all preload from the strut assembly.
16. Remove the center nut from the top of the strut.
17. Remove the top strut mount, rubber isolators, coil spring, and bump stop from the strut and set aside for use later.

Part Number: JBS-101-01

Product Line: JOURNEY BETTER LEVELING KITS

Page 2

Questions or Concerns?

Scan here:



or visit:
superspringsinternational.com

SAFETY NOTICE: We recommend installation be done by a professional or persons with sound mechanical knowledge.

WARNING: These instructions are a general guide for installation. SuperSprings International (SSI) assumes no liability for the actual installation process. Consumers and installers should apply common automotive safety practices when raising and working on any vehicle. **Do not put yourself in a position where, if the vehicle were to move unexpectedly, you may be injured.** SSI's products are designed to improve vehicle ride quality. Do not load any vehicle beyond the manufacturer's specifications.

Never exceed the manufacturer's Gross Vehicle Rating (GVWR) located on your vehicles identification tag.

BEFORE INSTALLATION: Ensure the vehicle is on a hard level surface, the parking brake is ON, with the ignition OFF, and place chocks in front of and behind the tires to prevent the vehicle from moving.

DURING AND/OR AFTER INSTALLATION: Ensure emergency brake cables are not touching the SSI products. Secure any cables out of the way with zip ties or by re-routing. Ensure all A/C lines, brake cables, and frame are clear of contact or interference.

REV. 1.01 | SEP 2023

PART NUMBER

JBS-101-01



JOURNEY BETTER
LEVELING KITS

INSTALLATION

JBS SHOCK ASSEMBLY

18. Refer to the diagram on page 1 for assembly of the JBS shock. **NOTE:** The 2" Spacer [ITEM B] must be installed to lift and level the front of the truck. If factory ride height is desired then this spacer will not be used.

19. Slide the 2" Lift Spacer [ITEM B] onto the body of the JBS Shock [ITEM A]. Ensure the lip of the spacer is facing down and is located properly on the welded ring of the shock body. (If factory ride height is desired, omit this step)

20. Transfer the plastic factory Lower Spring Isolator from OE spring seat to the JBS Spring Seat [ITEM C]. Slide the Spring Seat down the shock body so that it is located on the Spacer.

21. Slide the JBS Shock Cap [ITEM D] over the shaft and locate it on the top of the shock body. Tap downward with a soft face mallet until seated firmly on the shock body.

22. Install the factory bump stop onto the shock shaft as it came off the factory shock.

23. With the factory coil spring still compressed, slide it over the shock and locate on the spring seat.

24. Install the upper spring isolator and top mount and fasten in place with the supplied M12 Lock Nut [ITEM F]. Align all components as marked in Step 12. Ensure the lower mount is angled in the proper direction.

25. Torque the center Lock Nut [ITEM F] to 41 ft. lbs.

26. Place the strut assembly back into the chassis and install the three factory nuts. Leave the nuts loose.

27. Attach the lower strut mount to the lower control arm using the supplied M12 Bolts [ITEM E], Nyloc Nuts [ITEM F] and Washers [ITEM G] leaving loose for now.

28. Reattach the lower control arm to the frame using the factory hardware. Rotate the alignment cams to the original settings marked in Step 6. Snug down, but **do not tighten until the vehicle is back on the ground.**

29. Torque the three top nuts to 52 ft. lbs.

30. Torque the lower strut mount hardware to 66 ft. lbs.

31. Repeat steps 6 through 30 on the passenger side.

32. Reinstall the wheels and lug nuts.

33. Lift the vehicle and remove the jack stands.

34. Carefully lower the vehicle to the ground.

35. Torque the lower control arm bolts to 258 ft. lbs.

36. Torque the lug nuts to factory specifications.

37. Read and perform all tasks below under "Before Driving Your Vehicle".

38. Register the warranty for your SuperSprings International part. A warranty card can be found in the box your part came in.

Part Number: JBS-101-01

Product Line: JOURNEY BETTER LEVELING KITS

Page 3

Questions or Concerns?

Scan here:



or visit:
superspringsinternational.com

SAFETY NOTICE: We recommend installation be done by a professional or persons with sound mechanical knowledge.

WARNING: These instructions are a general guide for installation. SuperSprings International (SSI) assumes no liability for the actual installation process. Consumers and installers should apply common automotive safety practices when raising and working on any vehicle. **Do not put yourself in a position where, if the vehicle were to move unexpectedly, you may be injured.** SSI's products are designed to improve vehicle ride quality. Do not load any vehicle beyond the manufacturer's specifications.

Never exceed the manufacturer's Gross Vehicle Rating (GVWR) located on your vehicles identification tag.

BEFORE INSTALLATION: Ensure the vehicle is on a hard level surface, the parking brake is ON, with the ignition OFF, and place chocks in front of and behind the tires to prevent the vehicle from moving.

DURING AND/OR AFTER INSTALLATION: Ensure emergency brake cables are not touching the SSI products. Secure any cables out of the way with zip ties or by re-routing. Ensure all A/C lines, brake cables, and frame are clear of contact or interference.

REV. 1.01 | SEP 2023

PART NUMBER

JBS-101-01



JOURNEY BETTER
LEVELING KITS

INSTALLATION

BEFORE DRIVING YOUR VEHICLE:

It is important to double check all brake hoses, cables, and other components to be sure there is no interference. You must also check for wheel/tire to chassis/body interference. If any issues are found, review your installation instructions to be sure no steps were missed and any problems are corrected.

Make sure your vehicle is aligned immediately following installation.

Check all hardware and re-torque at intervals for the first 10, 100, and 1000 miles.

Some of SSI's products are designed to improve your vehicle's off-road performance. Leveling/lifting your vehicle may result in an altered center of gravity. It is crucial to use extreme care when operating your vehicle to prevent rollover and/or loss of control.

Any changes in your vehicle's suspension may result in transformed handleability. Please test-drive your vehicle in a remote location so you can become accustomed to the revised driving characteristics.

Perform headlight check and adjustment.

Part Number: JBS-101-01

Product Line: JOURNEY BETTER LEVELING KITS

Page 4

Questions or Concerns?

Scan here:



or visit:
superspringsinternational.com

SAFETY NOTICE: We recommend installation be done by a professional or persons with sound mechanical knowledge.

WARNING: These instructions are a general guide for installation. SuperSprings International (SSI) assumes no liability for the actual installation process. Consumers and installers should apply common automotive safety practices when raising and working on any vehicle. **Do not put yourself in a position where, if the vehicle were to move unexpectedly, you may be injured.** SSI's products are designed to improve vehicle ride quality. Do not load any vehicle beyond the manufacturer's specifications.

Never exceed the manufacturer's Gross Vehicle Rating (GVWR) located on your vehicles identification tag.

BEFORE INSTALLATION: Ensure the vehicle is on a hard level surface, the parking brake is ON, with the ignition OFF, and place chocks in front of and behind the tires to prevent the vehicle from moving.

DURING AND/OR AFTER INSTALLATION: Ensure emergency brake cables are not touching the SSI products. Secure any cables out of the way with zip ties or by re-routing. Ensure all A/C lines, brake cables, and frame are clear of contact or interference.

REV. 1.01 | SEP 2023

PART NUMBER

SSR-146-40/47



SCAN HERE: To watch a video of this installation



BEFORE YOU BEGIN

PRIMARY APPLICATIONS

- > Ford F-150 4 X 2
(2019 - present)
- > Ford F-150 4 X 4
(2019 - present)
- *NOT for Raptor Models

PARTS LIST

Item	Part #	Description	QTY
A	511440	SumoSprings Blue -40	2
	511421	SumoSprings Black -47	
B	512173	Frame Mounting Bracket	2
C	512174	SumoSpring Mounting Bracket	2
D	512312	M10-1.5 x 30mm Flange Bolt	2
E	512283	M8-1.25 x 25mm Flange Bolt	2
F	512371	M8-1.25 x 90mm SHCS	4
G	512215	M8 Flat Washer	8
H	512219	M8 Lock Nut	4

TOOLS REQUIRED

- > Floor Jack
- > Jack Stands
- > Wheel Chocks
- > 12, 13 & 15mm Wrenches
- > 12, 13 & 15mm Sockets
- > 6mm Allen Key

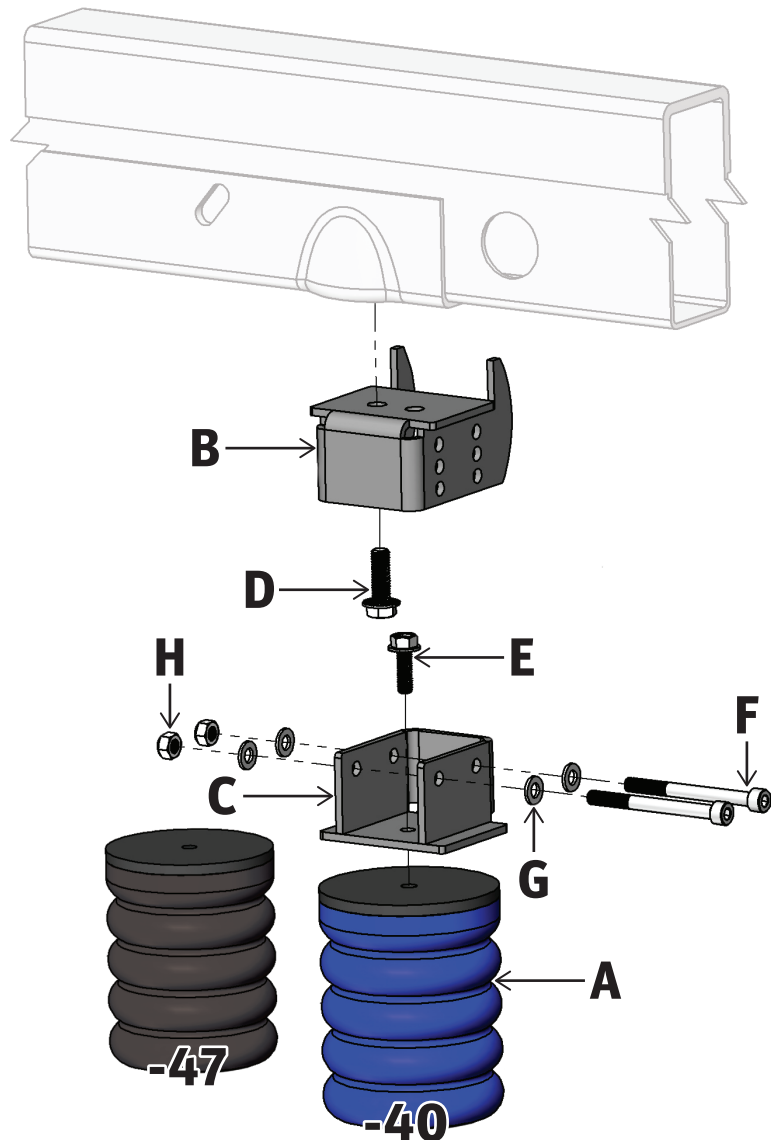

DRIVER SIDE (PASSENGER SIDE SIMILAR)

Part Number: SSR-146-40/47

Product Line: SUMOSPRINGS REAR

Page 1

Questions or Concerns?

Scan here:



or visit:
superspringsinternational.com

SAFETY NOTICE: We recommend installation be done by a professional or persons with sound mechanical knowledge.

WARNING: These instructions are a general guide for installation. SuperSprings International (SSI) assumes no liability for the actual installation process. Consumers and installers should apply common automotive safety practices when raising and working on any vehicle. **Do not put yourself in a position where, if the vehicle were to move unexpectedly, you may be injured.** SSI's products are designed to improve vehicle ride quality. Do not load any vehicle beyond the manufacturer's specifications.

Never exceed the manufacturer's Gross Vehicle Rating (GVWR) located on your vehicles identification tag.

BEFORE INSTALLATION: Ensure the vehicle is on a hard level surface, the parking brake is ON, with the ignition OFF, and place chocks in front of and behind the tires to prevent the vehicle from moving.

DURING AND/OR AFTER INSTALLATION: Ensure emergency brake cables are not touching the SSI products. Secure any cables out of the way with zip ties or by re-routing. Ensure all A/C lines, brake cables, and frame are clear of contact or interference.

PART NUMBER

SSR-146-40/47



INSTALLATION

1. Park the vehicle on a hard, level surface and engage the emergency brake. Place chocks in front and behind wheels to prevent rolling. Observe all safety precautions and wear safety glasses.
2. Measure the distance from the bottom of the frame to the top of the axle tube and record this dimension for later.
3. Raise the rear of the vehicle allowing the axle to hang freely and rest the frame on the safety jack stands rated for the weight of the vehicle. Removal of the rear wheels is optional.
4. Starting on the driver side, remove the existing factory bump stop using a 13mm socket.
5. Add a drop of Blue Thread Locker to the M10-1.5 x 30mm Flange Bolt [ITEM D] and attach the Frame Mounting Bracket [ITEM B] to the frame in the same location as the bump stop was previously. Make sure that the locating tangs are on the inside of the frame and use the forward bolt hole in the bracket to center the SumoSpring [ITEM A] over the axle.
6. Add a drop of Blue Thread Locker to the M8-1.25 x 25mm Flange Bolt [ITEM E] and attach the SumoSpring [ITEM A] to the SumoSpring Mounting Bracket [ITEM C].
7. The SumoSpring Mounting Bracket [ITEM C] fits into the Frame Mounting Bracket [ITEM B] with the open side facing outboard as seen in the diagram. Referring to the dimension taken in Step 2, align the holes in the SumoSpring Bracket with the set of holes in the Frame bracket that will allow for ½ to 1" of gap between the bottom of the SumoSpring and the axle tube.
8. Fasten the two brackets together with two M8-1.25 x 90mm SHCS [ITEM F], four M8 Flat Washers [ITEM G], and two M8 Lock Nuts [ITEM H].
9. Repeat steps 3 through 8 on the passenger side of the vehicle.
10. Raise the vehicle, remove safety jack stands, and carefully lower vehicle to the hard surface. Remove the chocks in front and back of the rear wheels.
11. Register the warranty for your SuperSprings International part. A warranty card can be found in the box your part came in.

Part Number: SSR-146-40/47

Product Line: SUMOSPRINGS REAR

Page 2

Questions or Concerns?

Scan here:



or visit:
superspringsinternational.com

SAFETY NOTICE: We recommend installation be done by a professional or persons with sound mechanical knowledge.

WARNING: These instructions are a general guide for installation. SuperSprings International (SSI) assumes no liability for the actual installation process. Consumers and installers should apply common automotive safety practices when raising and working on any vehicle. **Do not put yourself in a position where, if the vehicle were to move unexpectedly, you may be injured.** SSI's products are designed to improve vehicle ride quality. Do not load any vehicle beyond the manufacturer's specifications.

Never exceed the manufacturer's Gross Vehicle Rating (GVWR) located on your vehicles identification tag.

BEFORE INSTALLATION: Ensure the vehicle is on a hard level surface, the parking brake is ON, with the ignition OFF, and place chocks in front of and behind the tires to prevent the vehicle from moving.

DURING AND/OR AFTER INSTALLATION: Ensure emergency brake cables are not touching the SSI products. Secure any cables out of the way with zip ties or by re-routing. Ensure all A/C lines, brake cables, and frame are clear of contact or interference.

REV. 2.02 | SEP 2023